

Фланцевое соединение SFS 6000 PSI

Артикул штуцера	РУКАВ			ФЛАНЕЦ		
	DN	Дюймы	размер	F	D	
12 SFS 1/2"	12	1/2"	08	1/2"	31,7	
12 SFS 3/4"	12	1/2"	08	3/4"	41,3	
16 SFS 1/2"	16	5/8"	10	1/2"	31,7	
16 SFS 3/4"	16	5/8"	10	3/4"	41,3	
20 SFS 1/2"	20	3/4"	12	1/2"	31,7	
20 SFS 3/4"	20	3/4"	12	3/4"	41,3	
20 SFS 1"	20	3/4"	12	1"	47,6	
25 SFS 3/4"	25	1"	16	3/4"	41,3	
25 SFS 1"	25	1"	16	1"	47,6	
25 SFS 1.1/4"	25	1"	16	1.1/4"	54,0	
32 SFS 1"	32	1.1/4"	20	1"	47,6	
32 SFS 1.1/4"	32	1.1/4"	20	1.1/4"	54,0	
32 SFS 1.1/2"	32	1.1/4"	20	1.1/2"	63,5	
40 SFS 1.1/2"	40	1.1/2"	24	1.1/2"	63,5	
40 SFS 2"	40	1.1/2"	24	2"	79,4	
50 SFS 2"	40	1.1/2"	24	2"	79,4	

Угловое 90° фланцевое соединение SFS 6000 PSI

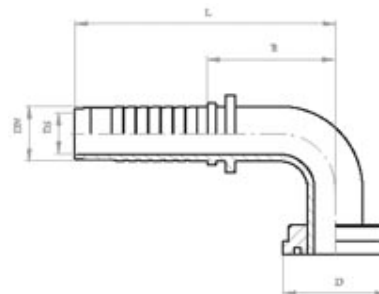

Артикул штуцера	РУКАВ			ФЛАНЕЦ		
	DN	Дюймы	размер	F	D	
12-90 SFS 1/2"	12	1/2"	08	1/2"	31,7	
12-90 SFS 3/4"	12	1/2"	08	3/4"	41,3	
16-90 SFS 1/2"	16	5/8"	10	1/2"	31,7	
16-90 SFS 3/4"	16	5/8"	10	3/4"	41,3	
20-90 SFS 1/2"	20	3/4"	12	1/2"	31,7	
20-90 SFS 3/4"	20	3/4"	12	3/4"	41,3	
20-90 SFS 1"	20	3/4"	12	1"	47,6	
25-90 SFS 3/4"	25	1"	16	3/4"	41,3	
25-90 SFS 1"	25	1"	16	1"	47,6	
25-90 SFS 1.1/4"	25	1"	16	1.1/4"	54,0	
32-90 SFS 1"	32	1.1/4"	20	1"	47,6	
32-90 SFS 1.1/4"	32	1.1/4"	20	1.1/4"	54,0	
32-90 SFS 1.1/2"	32	1.1/4"	20	1.1/2"	63,5	
40-90 SFS 1.1/2"	40	1.1/2"	24	1.1/2"	63,5	
40-90 SFS 2"	40	1.1/2"	24	2"	79,4	
50-90 SFS 2"	40	1.1/2"	24	2"	79,4	

Угловое 45° фланцевое соединение SFS 6000 PSI

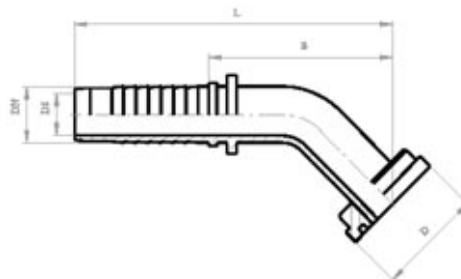

Артикул штуцера	РУКАВ			ФЛАНЕЦ		
	DN	Дюймы	размер	F	D	
12-45 SFS 1/2"	12	1/2"	08	1/2"	31,7	
12-45 SFS 3/4"	12	1/2"	08	3/4"	41,3	
16-45 SFS 1/2"	16	5/8"	10	1/2"	31,7	
16-45 SFS 3/4"	16	5/8"	10	3/4"	41,3	
20-45 SFS 1/2"	20	3/4"	12	1/2"	31,7	
20-45 SFS 3/4"	20	3/4"	12	3/4"	41,3	
20-45 SFS 1"	20	3/4"	12	1"	47,6	
25-45 SFS 3/4"	25	1"	16	3/4"	41,3	
25-45 SFS 1"	25	1"	16	1"	47,6	
25-45 SFS 1.1/4"	25	1"	16	1.1/4"	54,0	
32-45 SFS 1"	32	1.1/4"	20	1"	47,6	
32-45 SFS 1.1/4"	32	1.1/4"	20	1.1/4"	54,0	
32-45 SFS 1.1/2"	32	1.1/4"	20	1.1/2"	63,5	
40-45 SFS 1.1/2"	40	1.1/2"	24	1.1/2"	63,5	
40-45 SFS 2"	40	1.1/2"	24	2"	79,4	
50-45 SFS 2"	40	1.1/2"	24	2"	79,4	